



Product designation
Product type designation
Motor type

Soft starter basic
ADXNB
Asynchronous
three phase

Electrical features

Supplies voltage

	Type of system		Three phase
	Rated supply voltage	V	208...600VAC
	auxiliary supply voltage (Us)		24VAC/DC
	Rated frequency	Hz	50/60
Rated starter current Ie		A	30
Rated motor power	IEC ratings (T≤40°C)		
	230VAC	kW	7.5
	400VAC	kW	15
	500VAC	KW	18.5
	UL ratings (T≤40°C)		
	220-240VAC	HP	10
	380-415VAC	HP	15
	440-480VAC	HP	20
	550-600VAC	HP	25
Number of controlled phases		Nr.	2
Built-in bypass			Yes
Cooling System			Natural or forced (optional)
Rated insulation voltage Ui		V	600

Programming interface

Potentiometer	Settings: starting voltage, acceleration ramp, deceleration ramp		
Display	No		
Programming with NFC technology	No		
Optical port	No		

Startup and stop settings

Startup method	Voltage ramp		
Stop method	Voltage ramp or free-wheel stop		
Acceleration ramp	s	1-20	
Deceleration ramp	s	0-20	
Startup voltage	%	30-80	

Protections

Power supply Protection				No power line, phase loss, frequency out of limits, phase sequence (configurable)
Starter protection				Overtemperature
Input and Output				
Digital inputs				
	Number of digital input	Nr.	1	
	Digital input type		Volt-free contact	
	Digital input functions		Motor start	
Digital outputs				
	Number of digital output	Nr.	2	
	Digital output arrangement		2 NO contacts with the same common, 5A 250VAC AC1 - 5A 30 VDC	
	Digital output functions		Line contactor (Run), TOR (Top Of Ramp)	
Communication interfaces				
Communication interface				No
Ambient conditions				
Temperature				
	Operating temperature			
		min	°C	-20
		max	°C	+60°C (with current derating >40°C)
	Storage temperature			
		min	°C	-30
		max	°C	+80
Max altitude				1000 without derating of the starter current
Relative humidity				% <80%
Pollution degree				2
Installation category				III
Housing				
Mounting				Screw-fixing or 35mm DIN rail (IEC/EN/BS 60715)
IP degree of protection				IP20
Dimensions (W x H x D)	mm	45 x 159 x 128.4		
Weight	Kg	0.63		
Dimensions				

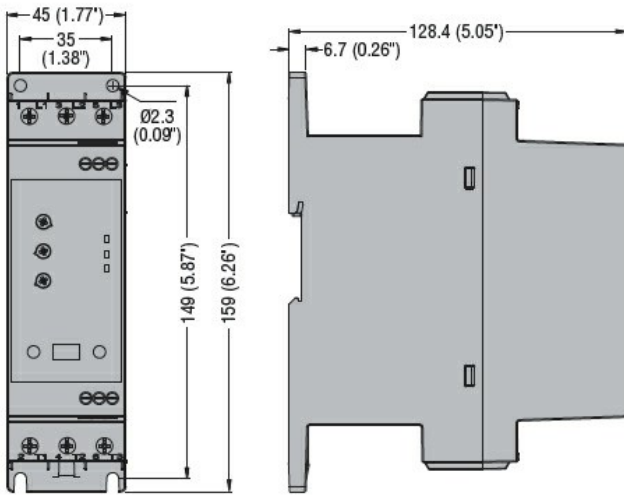

Certifications and compliance

Compliance

- CSA C22.2 n° 60947-4-2
- IEC/EN/BS 60947-1
- IEC/EN/BS 60947-4-2
- UL 60947-4-2

Certificates

- cULus
- EAC
- RCM (pending)

ETIM classification

ETIM 8.0

EC000640 - Soft starter